

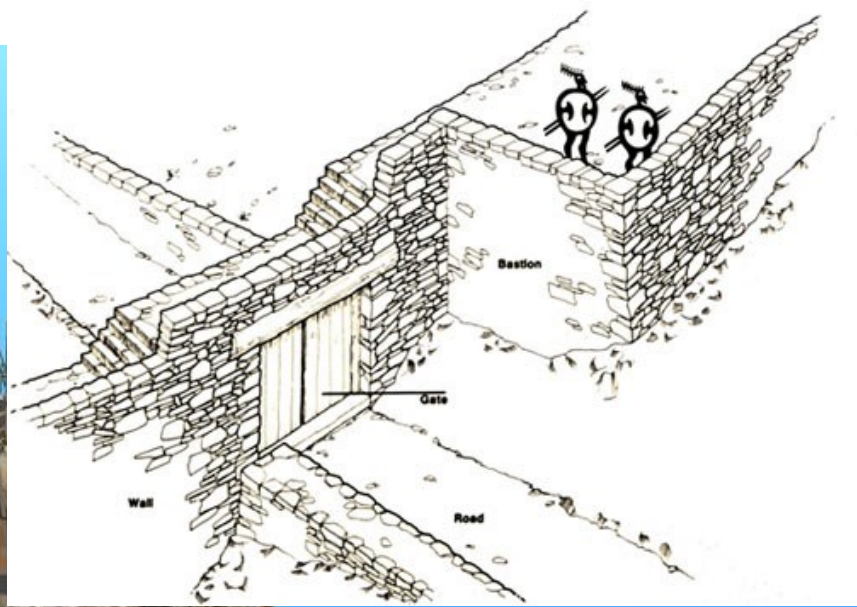

© www.AncientAthens3d.com

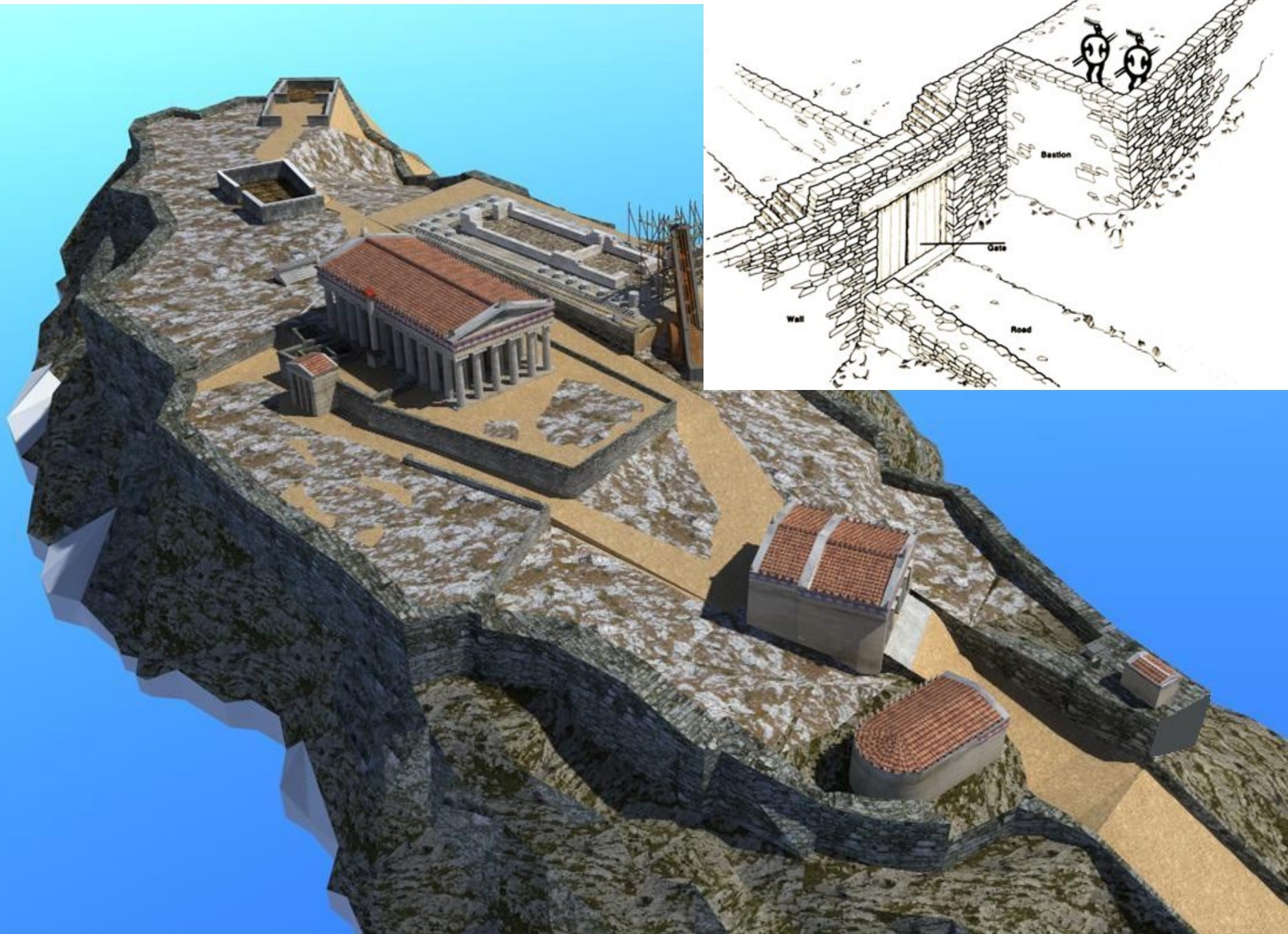

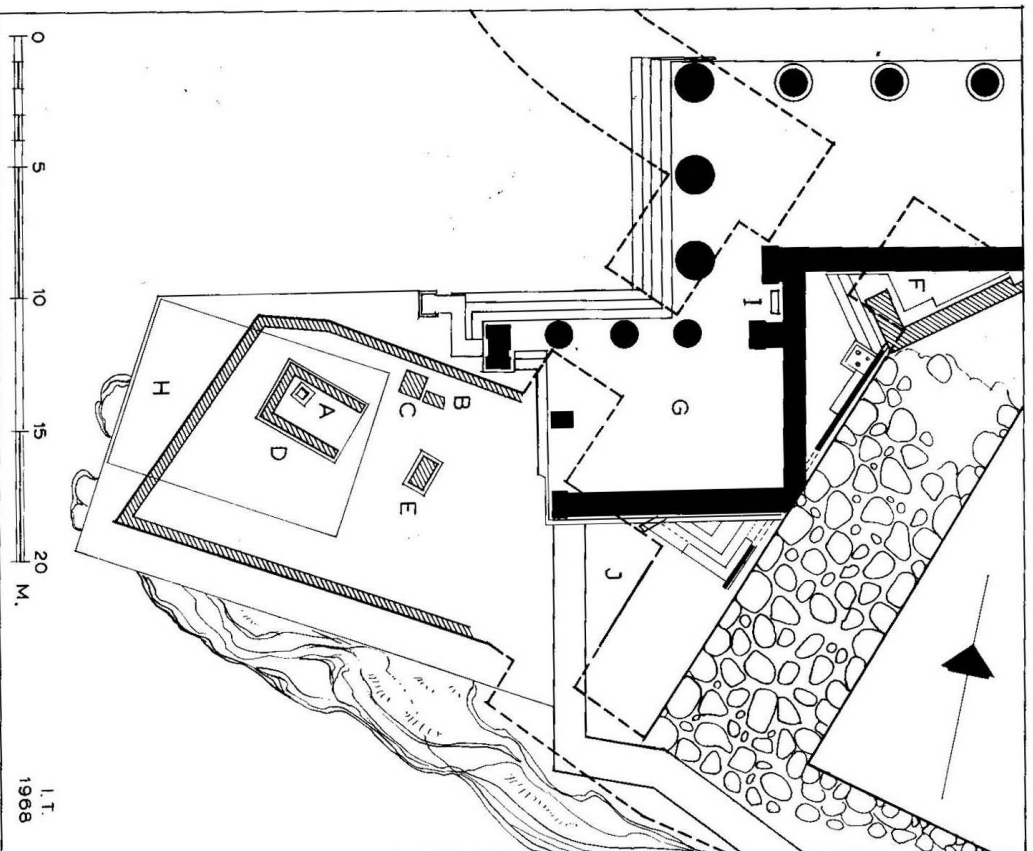



200 Mycenaean gateway restored, shown in broken lines in relation to the Propylaea and the shrine of Athena Nike.

A. Base, fig. 201 - B. Inscribed altar - C. Base - D. Poros naiskos - E. Altar - F. Corner of Old Propylon
 G. South wing of the Mnesikleian Propylaea - H. Bastion and marble temple of Athena Nike - I. The Graecus - J. Shrine of Artemis Epipyrgidia.

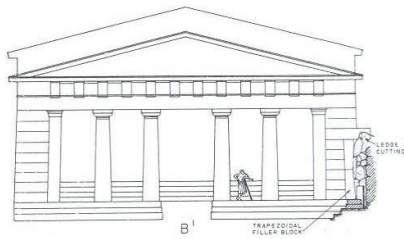

B'

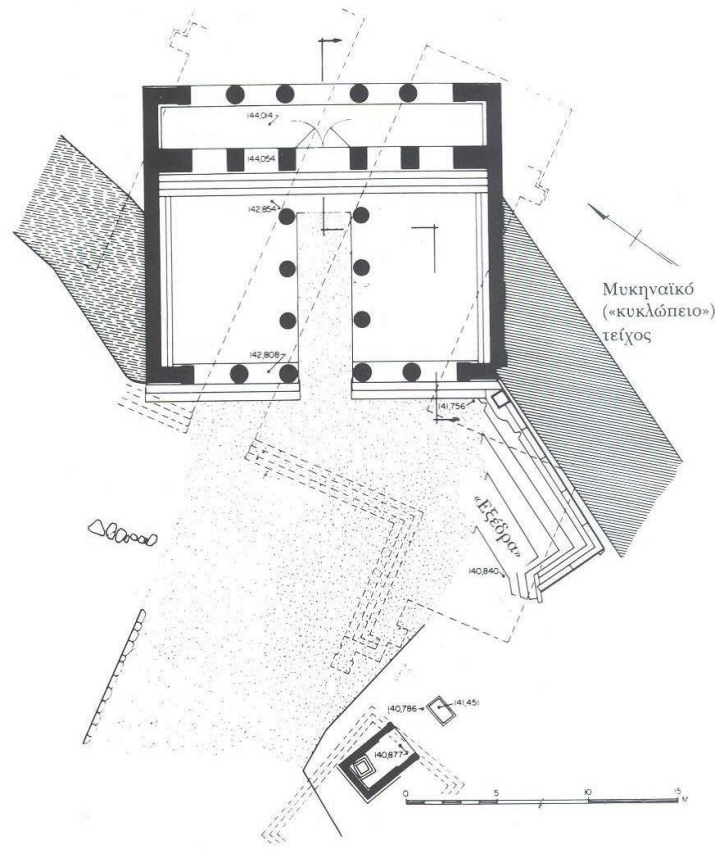



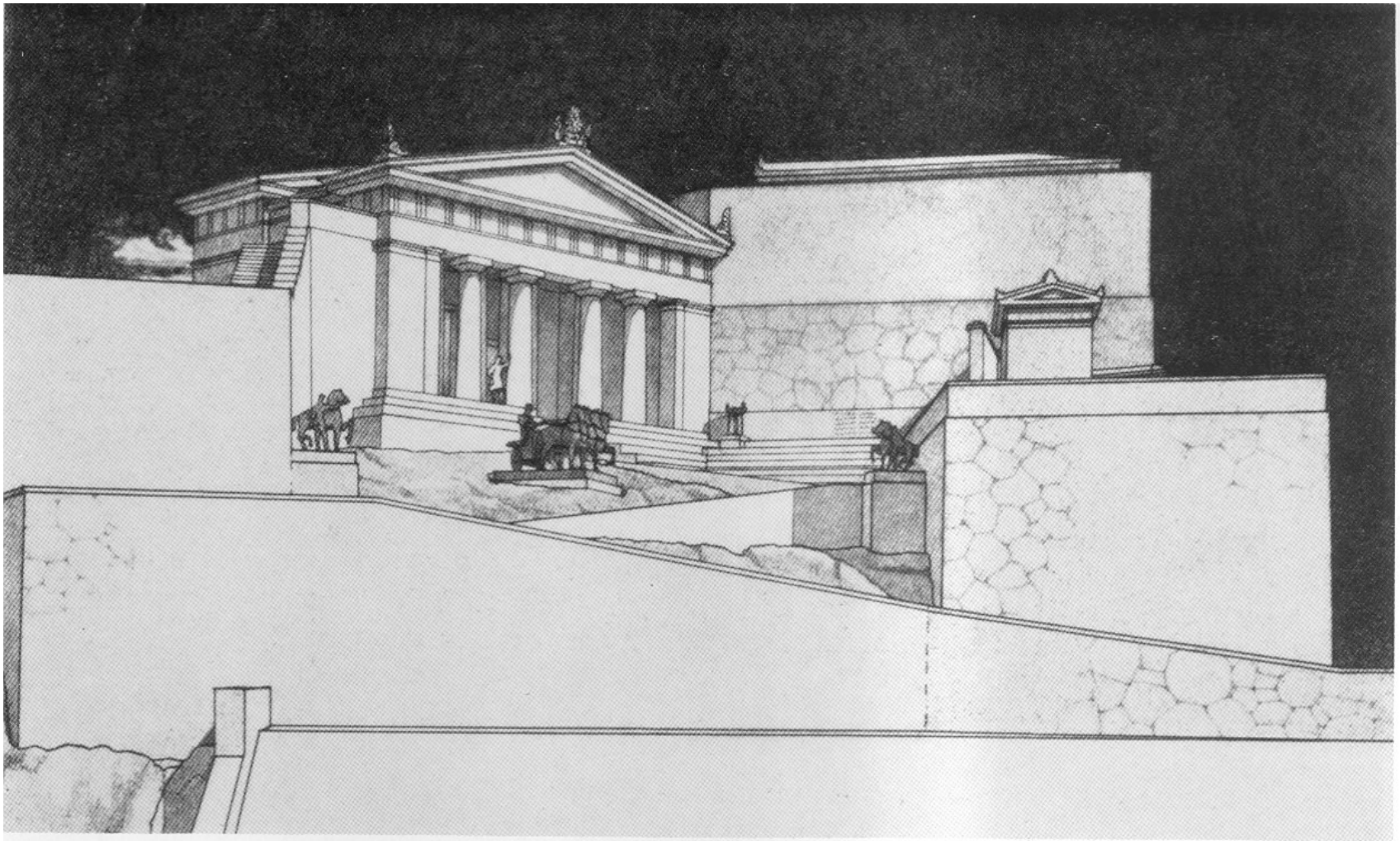

511 Old Propylon on the Acropolis, built 488–480 B.C., which stood until 437 B.C. Restored by G. P. Stevens.



ORACLE: τεῖχος Τριτογενεῖ ξύλινον διδοῖ εὐρύοπα Ζεὺς
μοῦνον ἀπόρθητον τελέθειν, τὸ σὲ τέκνα τ' ὀνήσει.



THE ACROPOLIS OF ATHENS: PROPYLAEAE



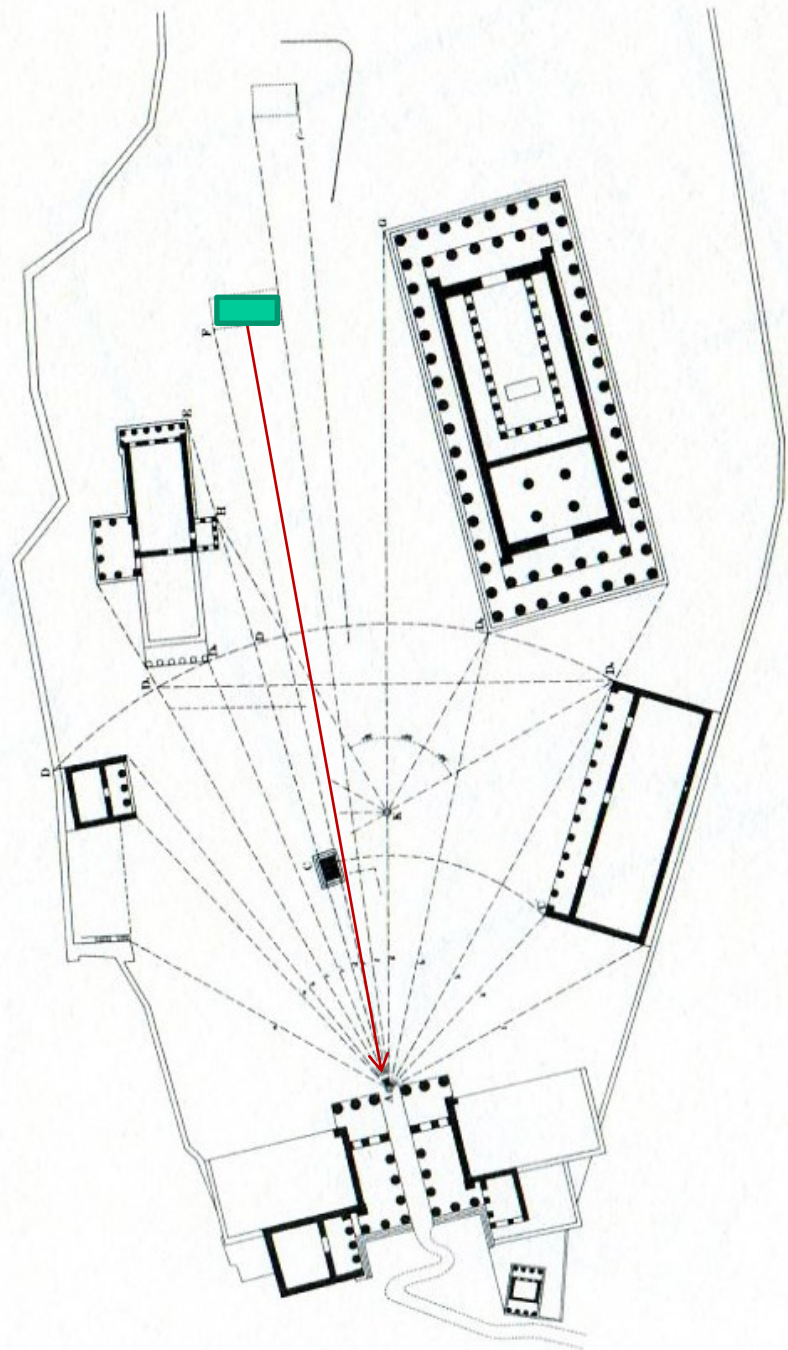
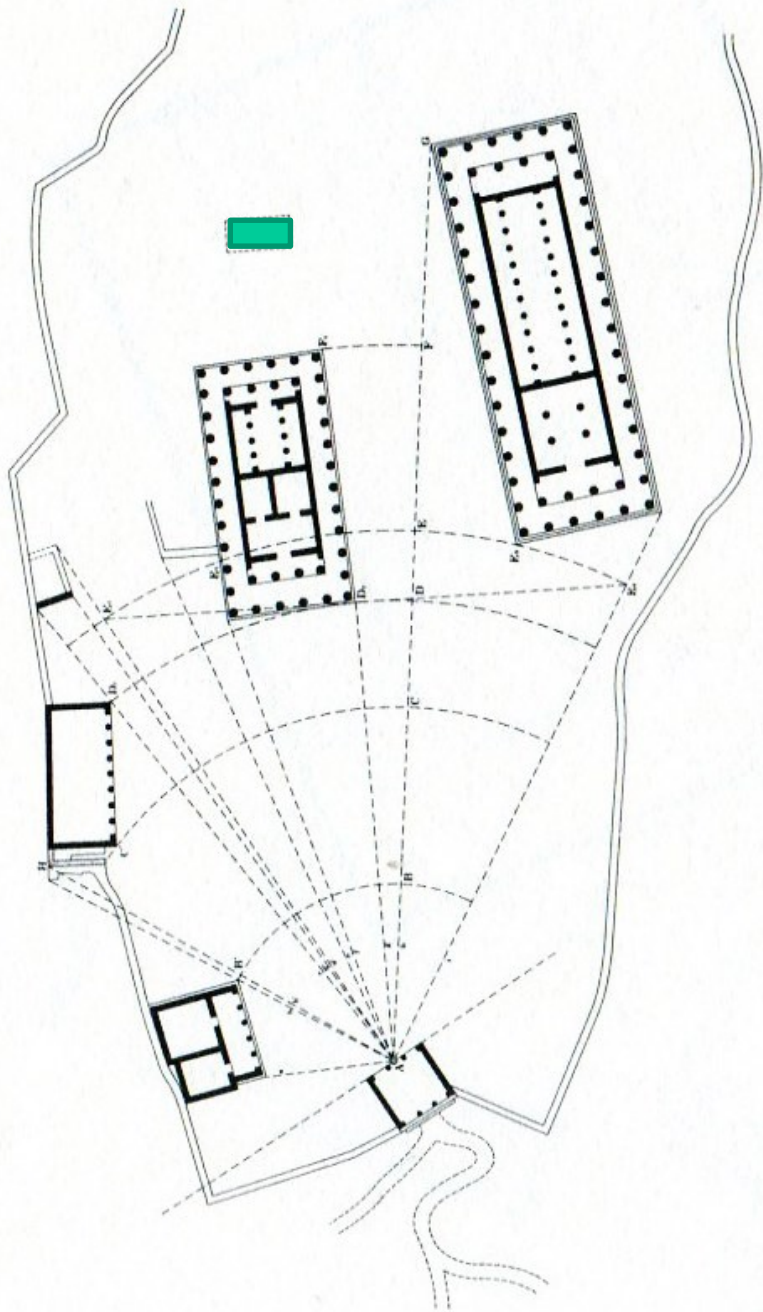

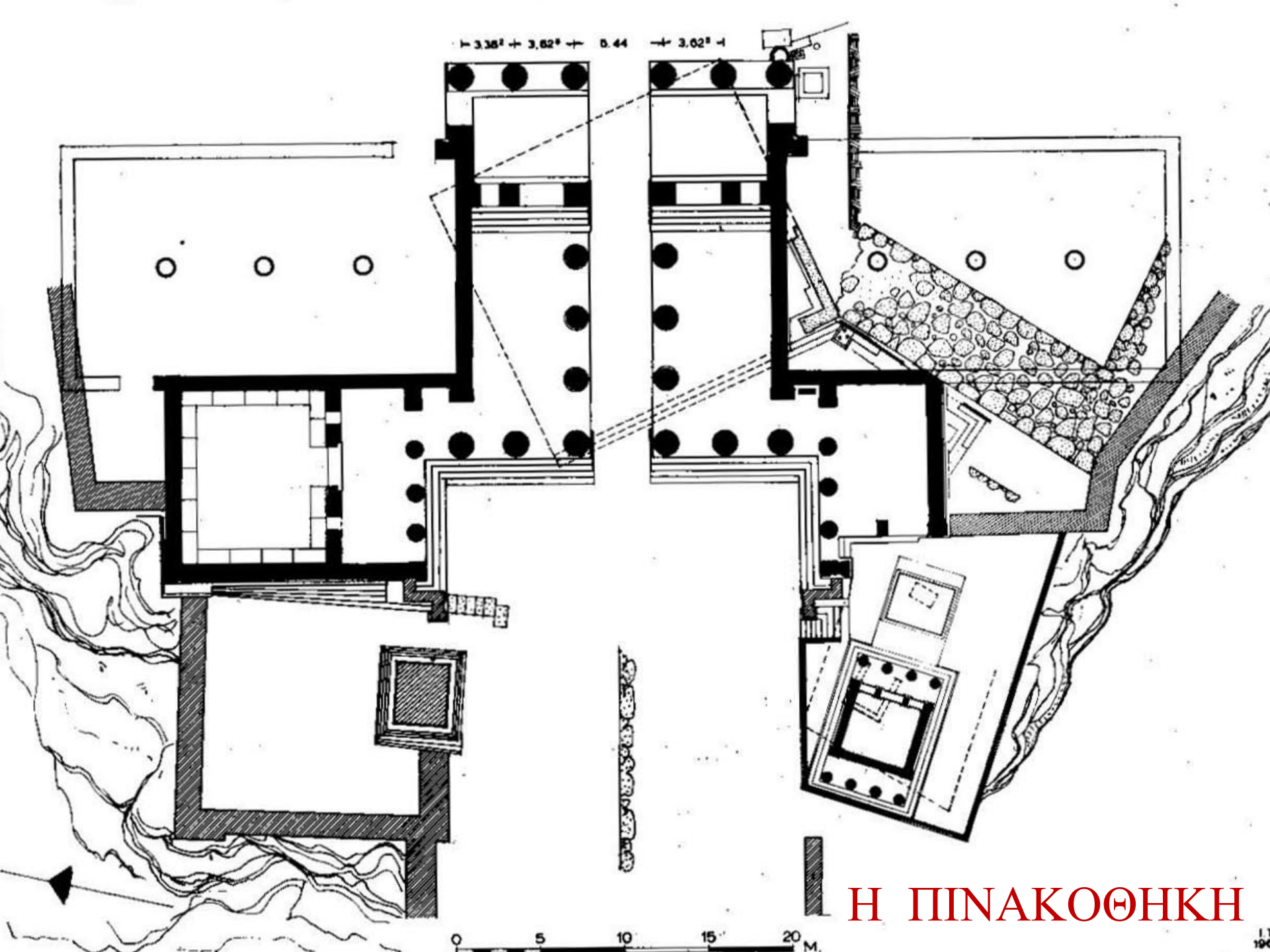

→ 3.38² + 3.62² + 0.44 ← 3.62² ←

Η ΠΙΝΑΚΟΘΗΚΗ

0 5 10 15 20 M.

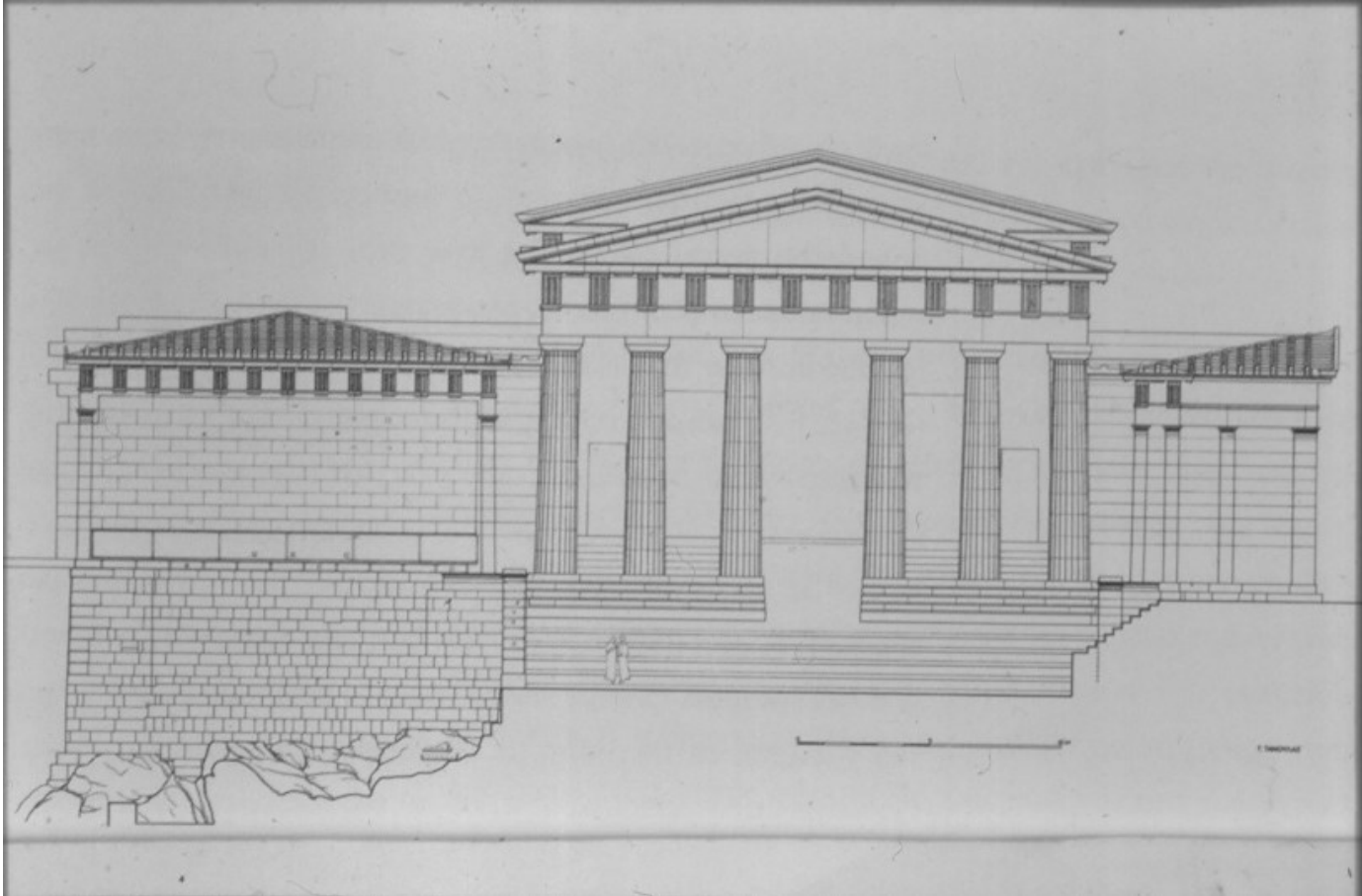







Overall View



Pinacotheca



© 2003 The Museum of Reconstructions, Inc.

West Facade



© 2003 The Museum of Reconstruct

Main Hall



© 2003 The Museum of Reconstruct

- IONIC COLUMNS WITH
- ENTASIS

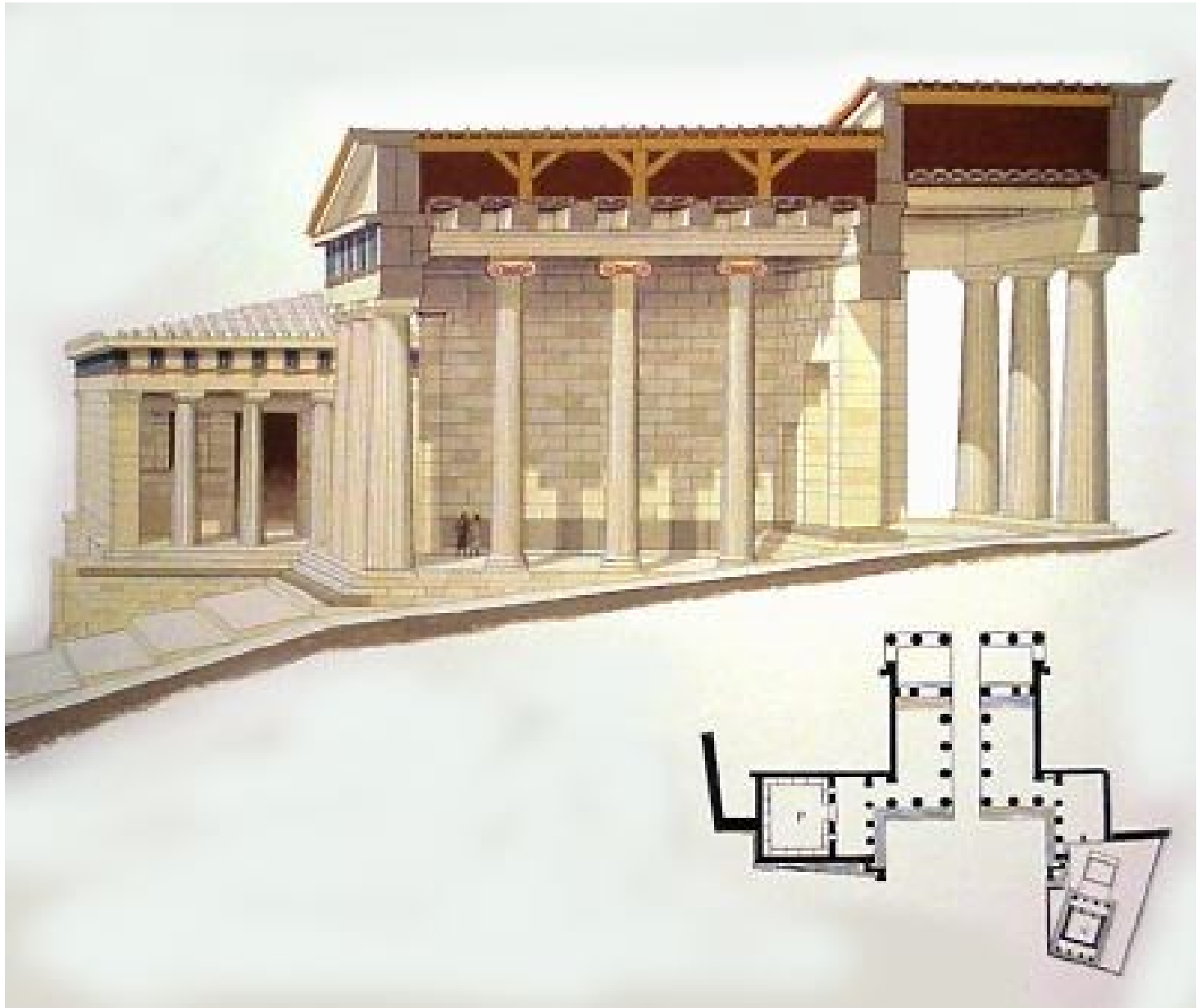

THE ACROPOLIS OF ATHENS: PROPYLAEA



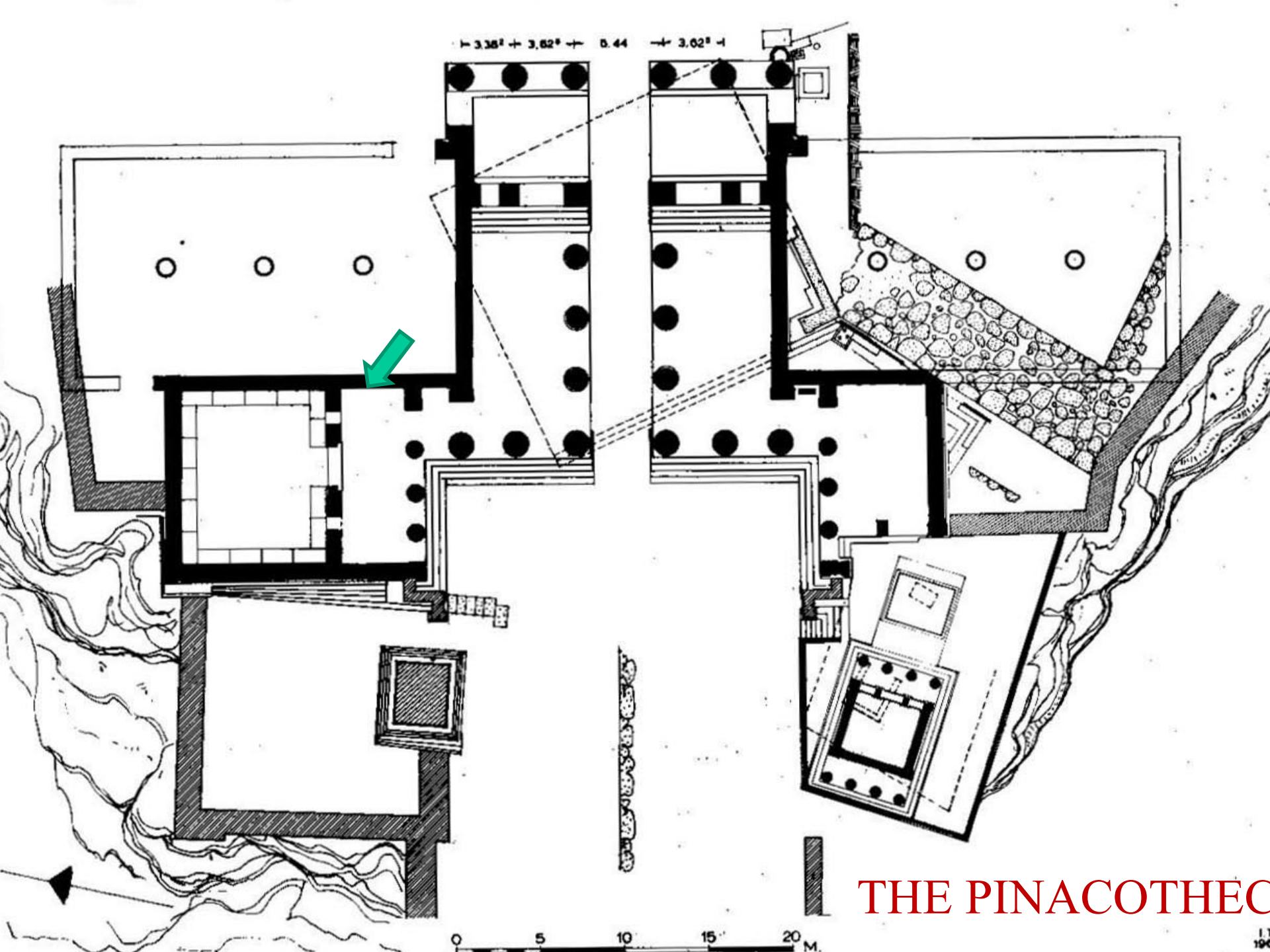

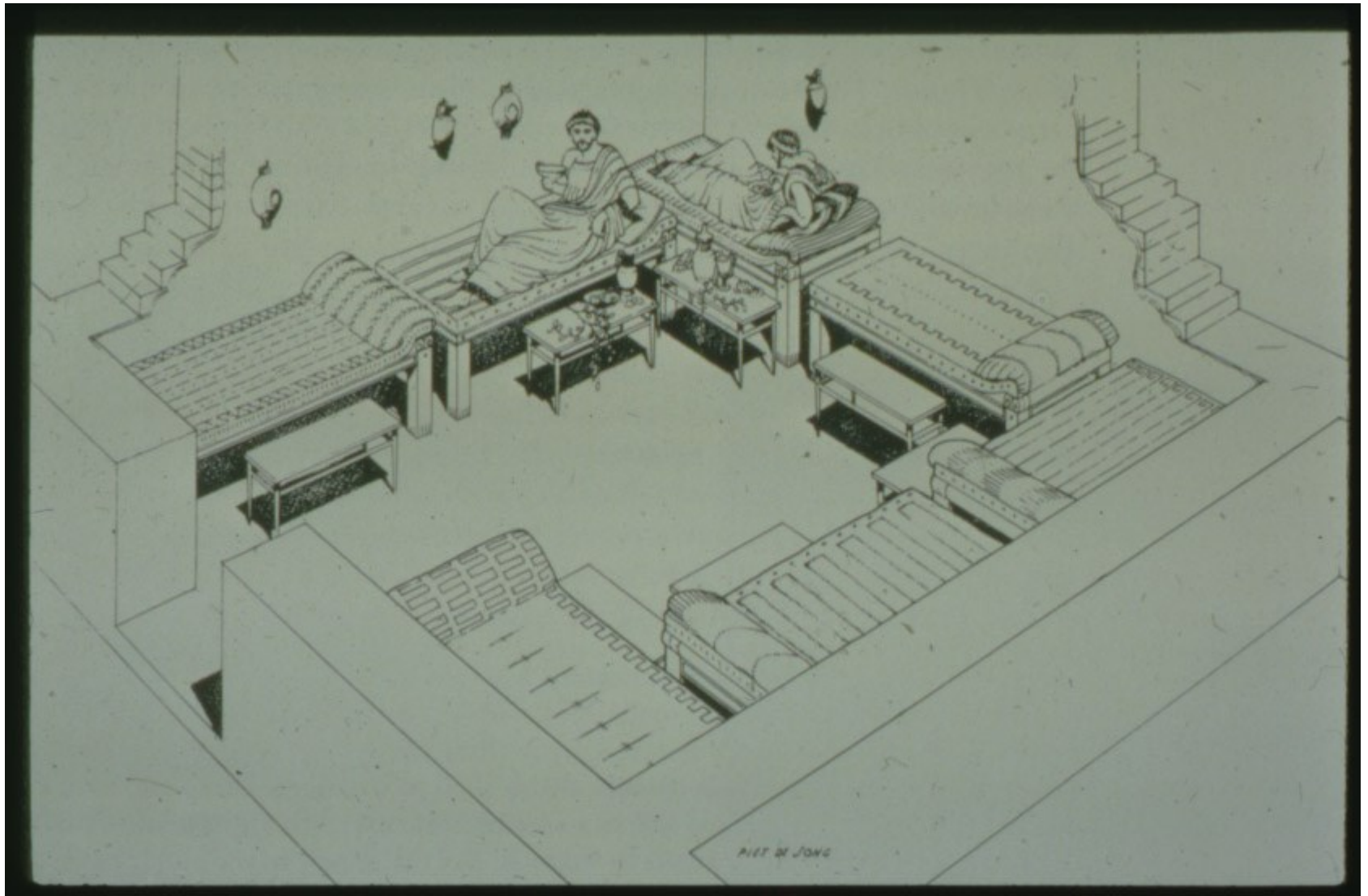

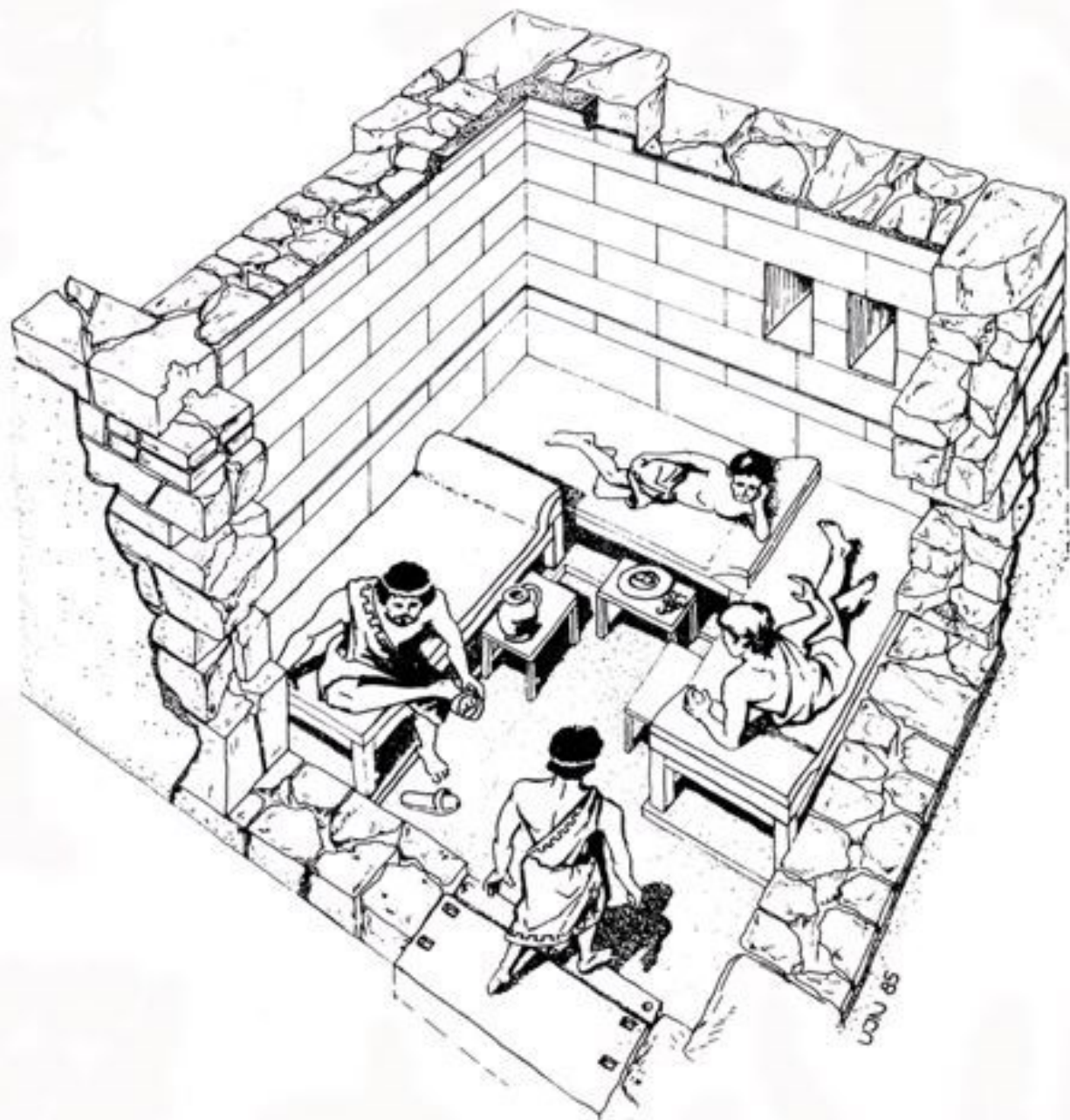

SP. NOV.

Pinacotheca



© 2003 The Museum of Reconstructions, Inc.



TEMPLE OF ATHENA NIKE

AFTER 421 B.C.

8,27 x 5,64 m.





Overall View



Καλλικράτης

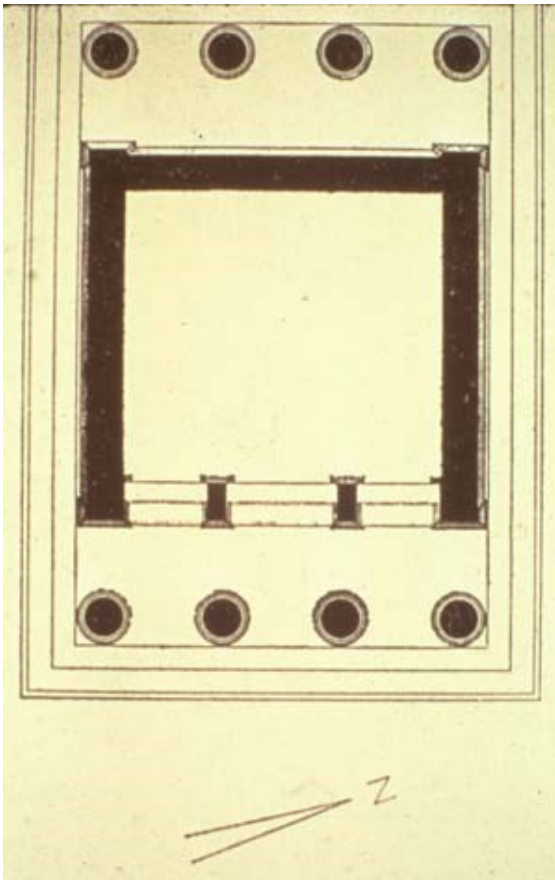

Temple of Athena Nike



- SHORTEST KNOWN IONIC COLUMNS
- PEDIMENTAL SCULPTURES





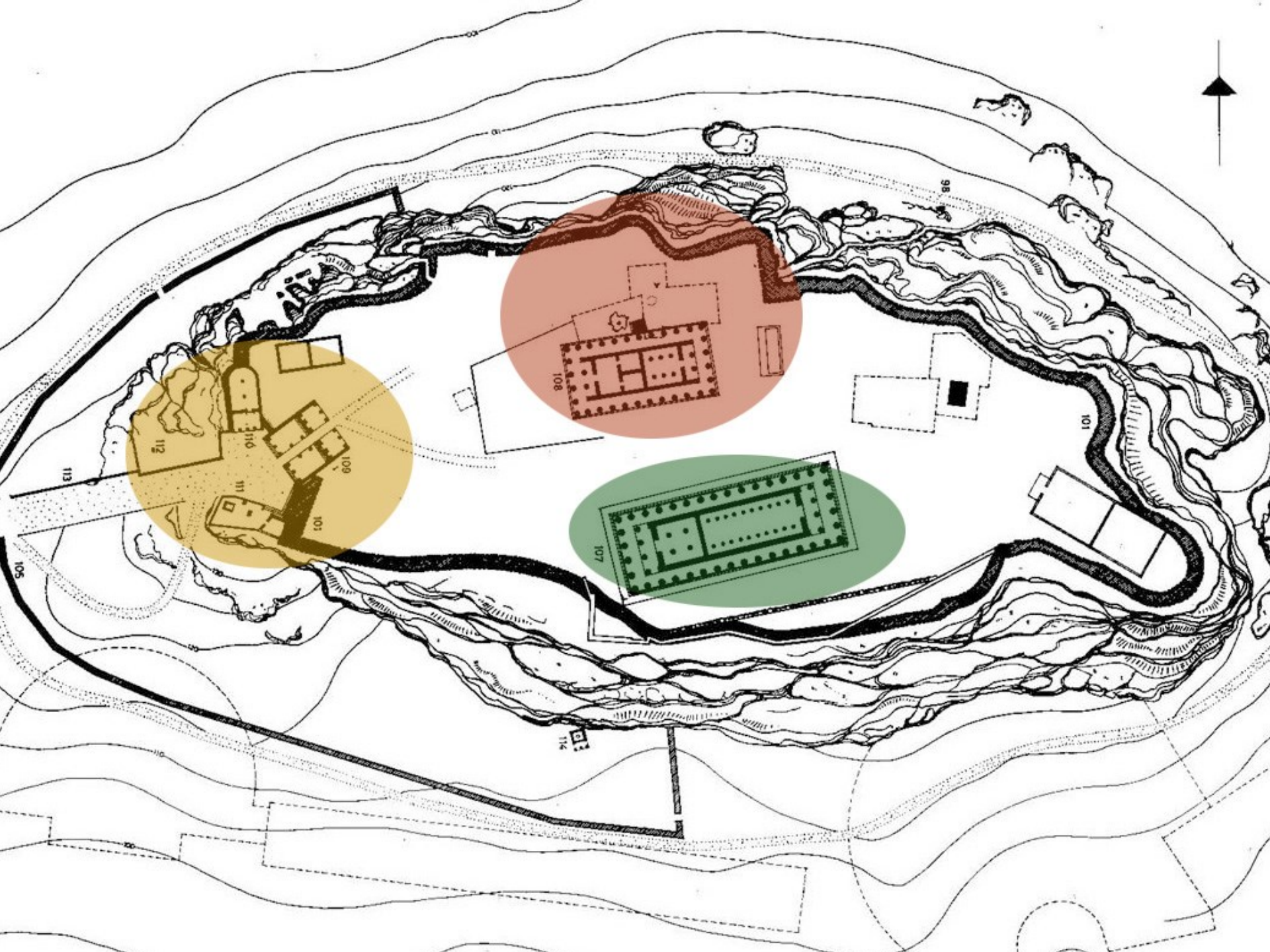

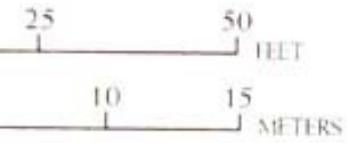

...ing wooden image of Athena
...ive tree
...trident mark
...rchaic temple

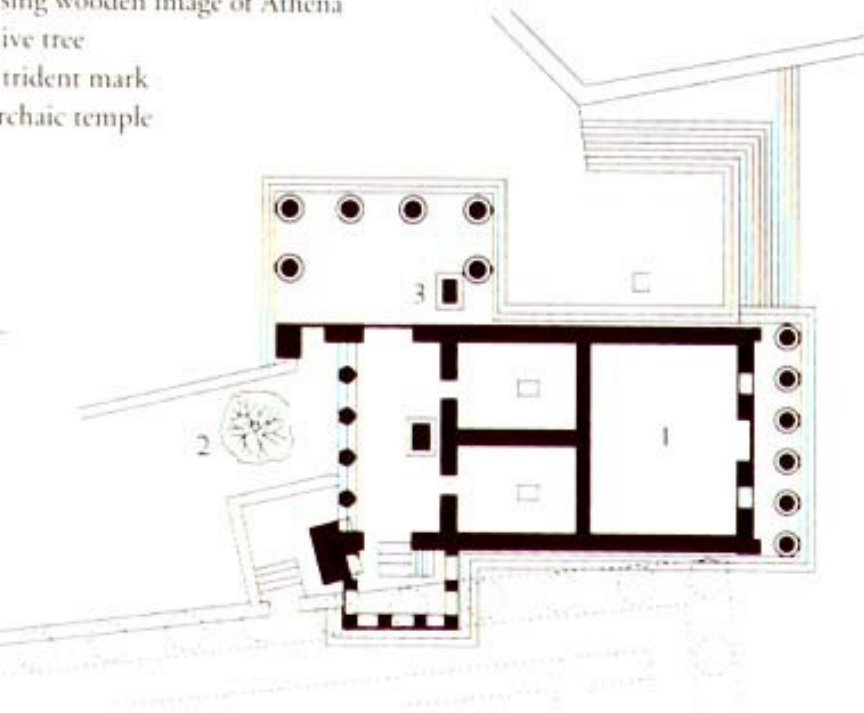

Plan of the Erechtheion, Acropolis, Athens, Greece

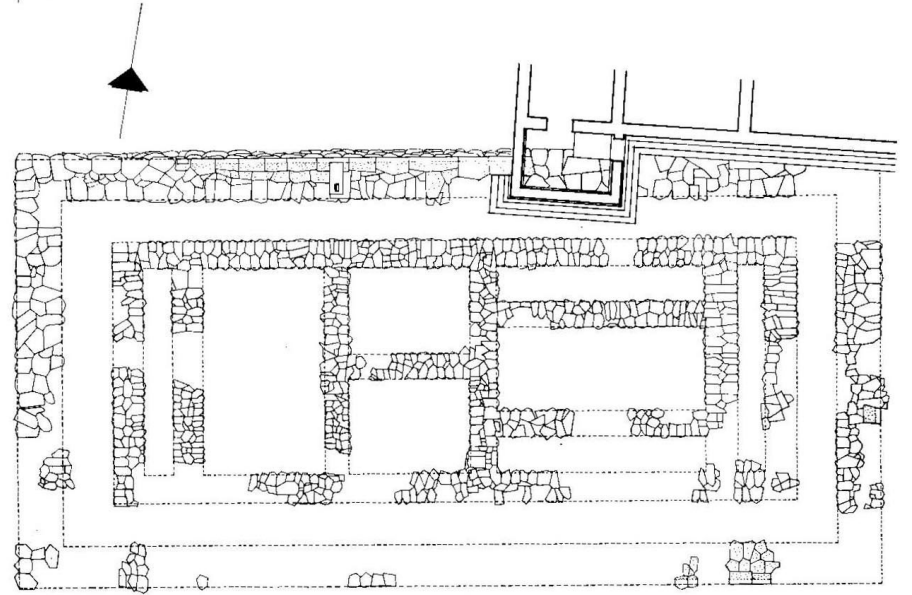
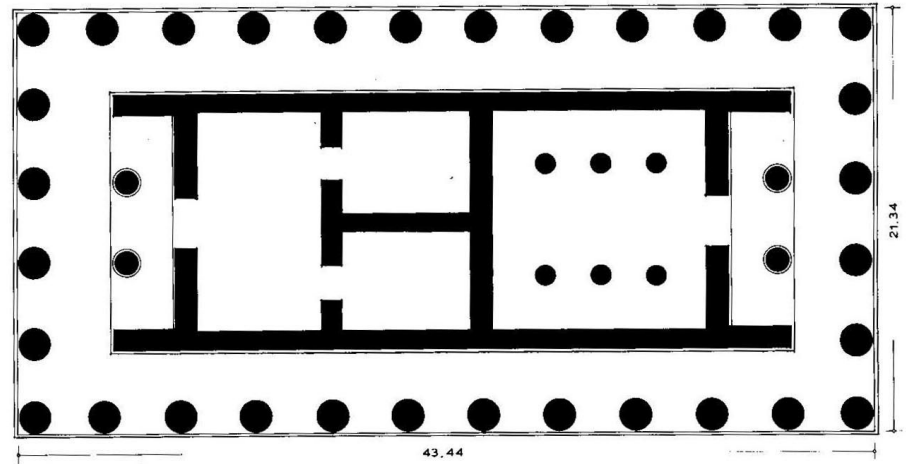

196 Old Temple of Athena on the Acropolis, south of the Erechtheion. 529–520 B.C. Above: restored plan. Below actual state plan.

THE OLD TEMPLE OF ATHENA

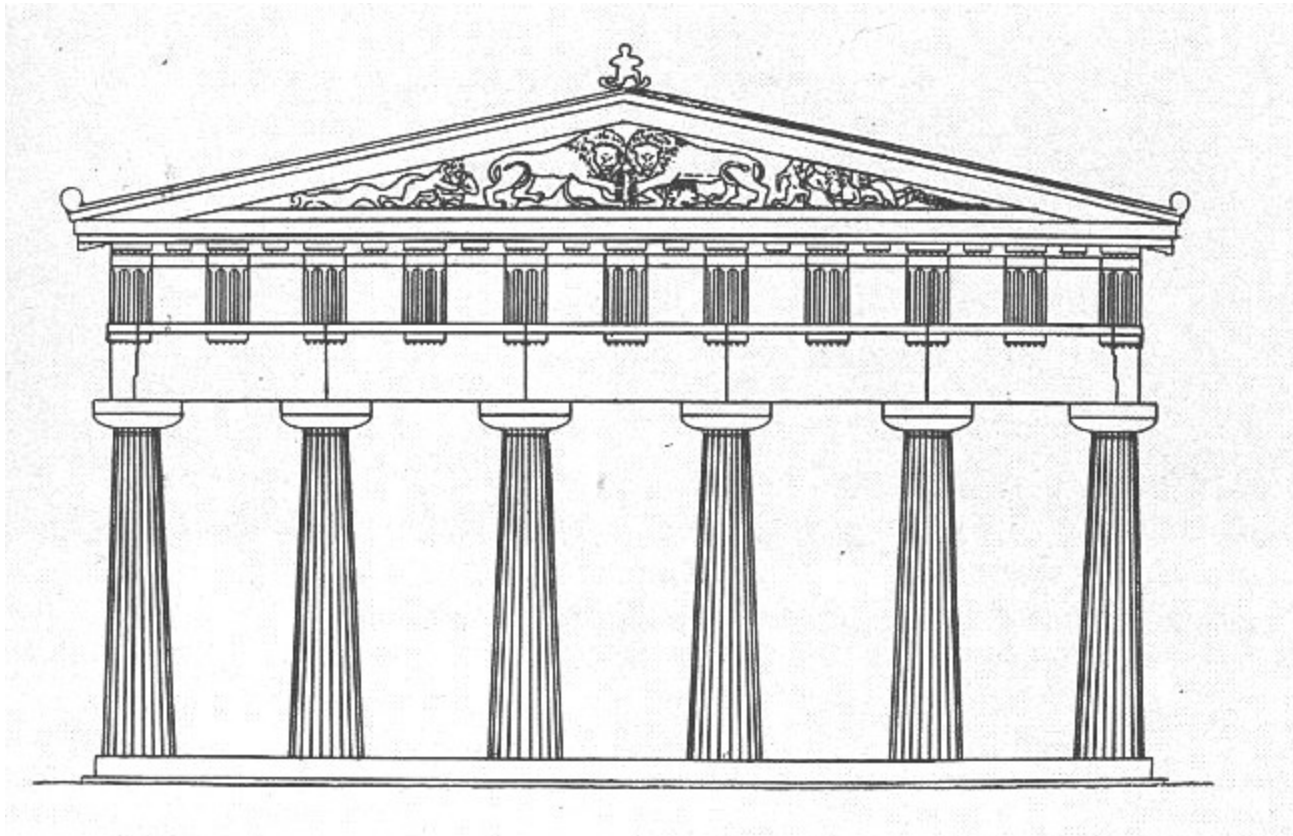

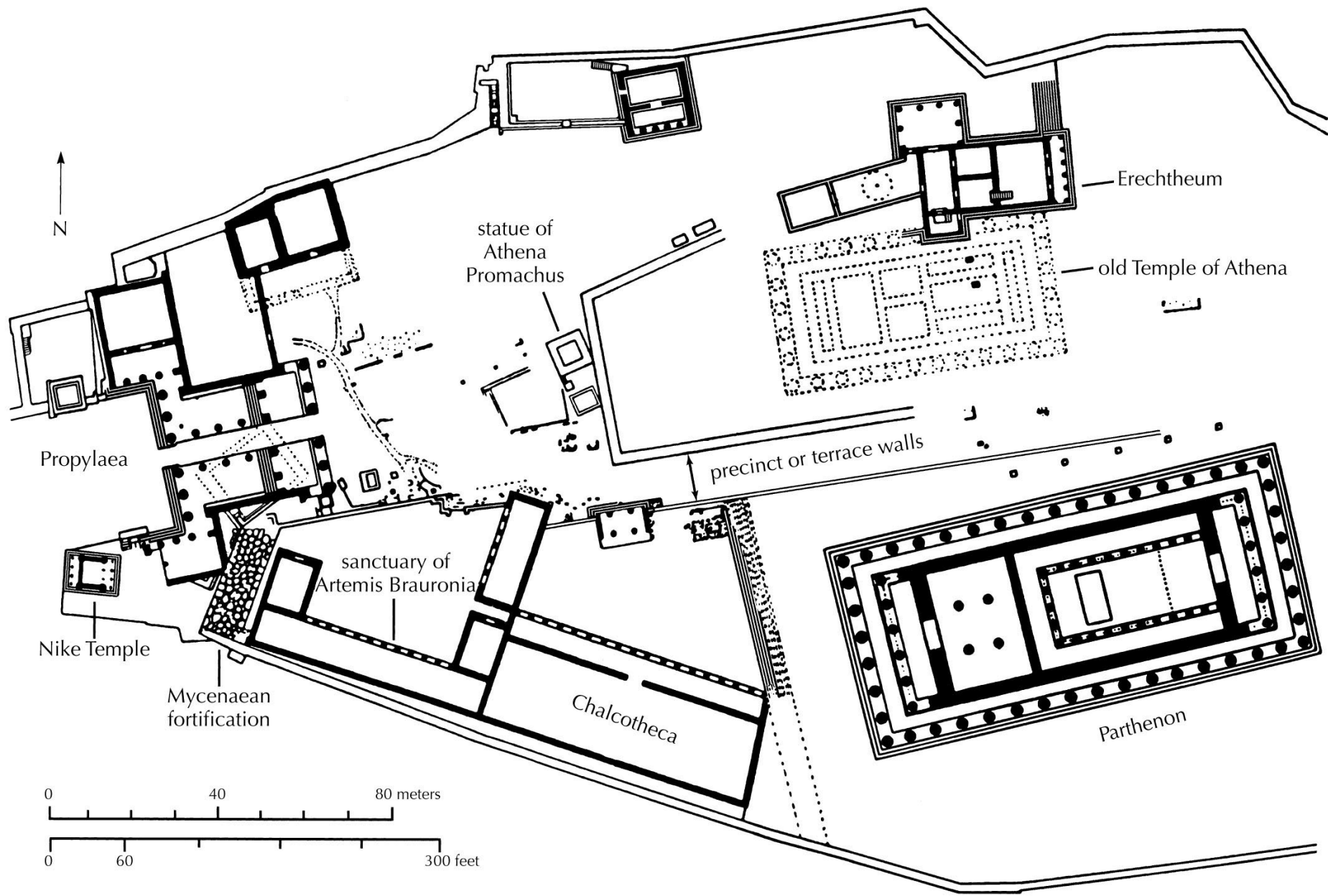



. τῷ δ' ἐπιόντι ἔτει, ᾧ ἢ τε σελήνη ἐξέλιπεν ἑσπέρας καὶ ὁ παλαιὸς τῆς Ἀθηνᾶς νεὸς ἐν Ἀθήναις ἐνεπρήσθη, Ξενοφών, *Ἑλληνικά* 1.6.1.

THE ERECHTHEION

HEROON, TEMPLE, STORAGE OF ATHENA'S GARMENT

“

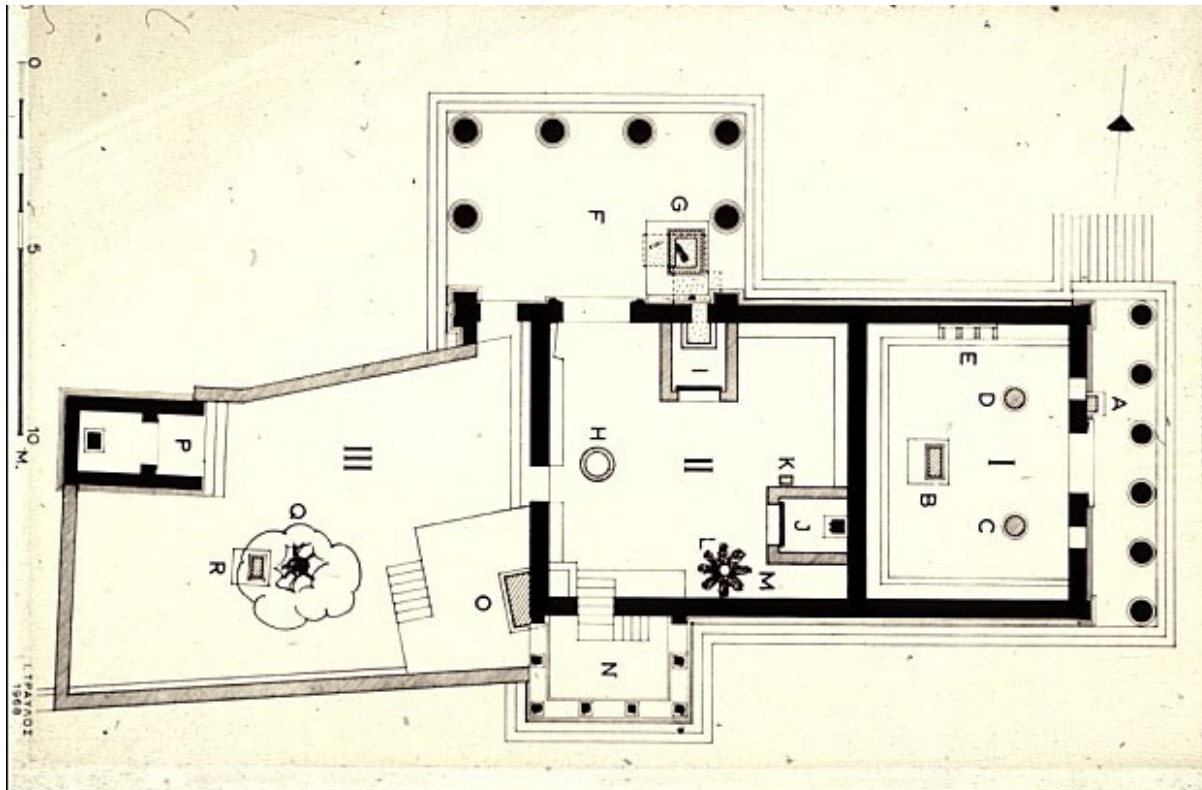

389) Plan by John Travlos with location of various cults, artifacts, etc., Erechtheion, north side of Akropolis, 421-415 & 409-406 B.C.



... CONTRASTED WITH THE SIMPLE DORIC
PARTHENON



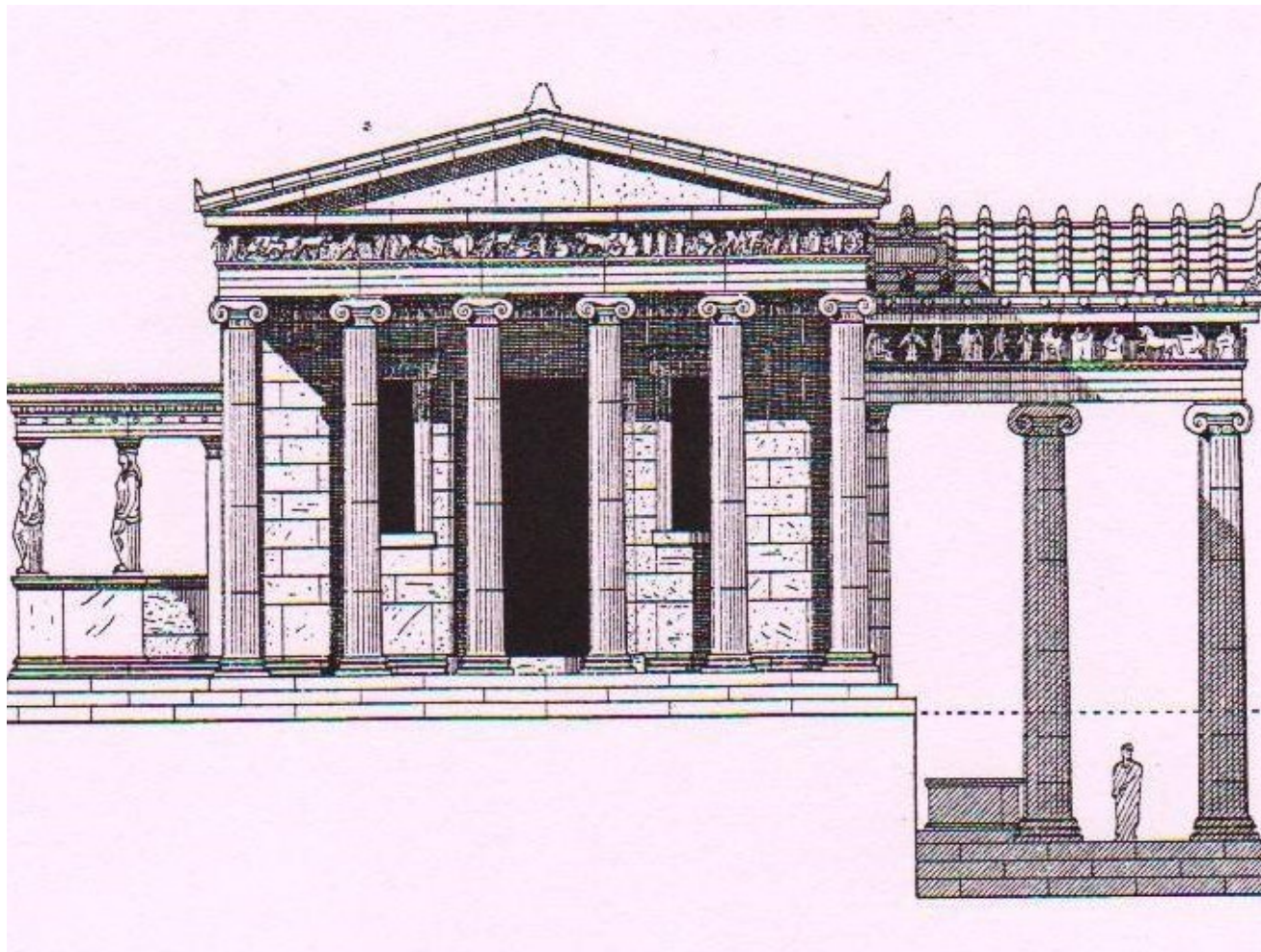

Η ανατολική πρόσταση του ναού.



THE EAST PORCH

- MOST SLENDER IONIC COLUMNS!

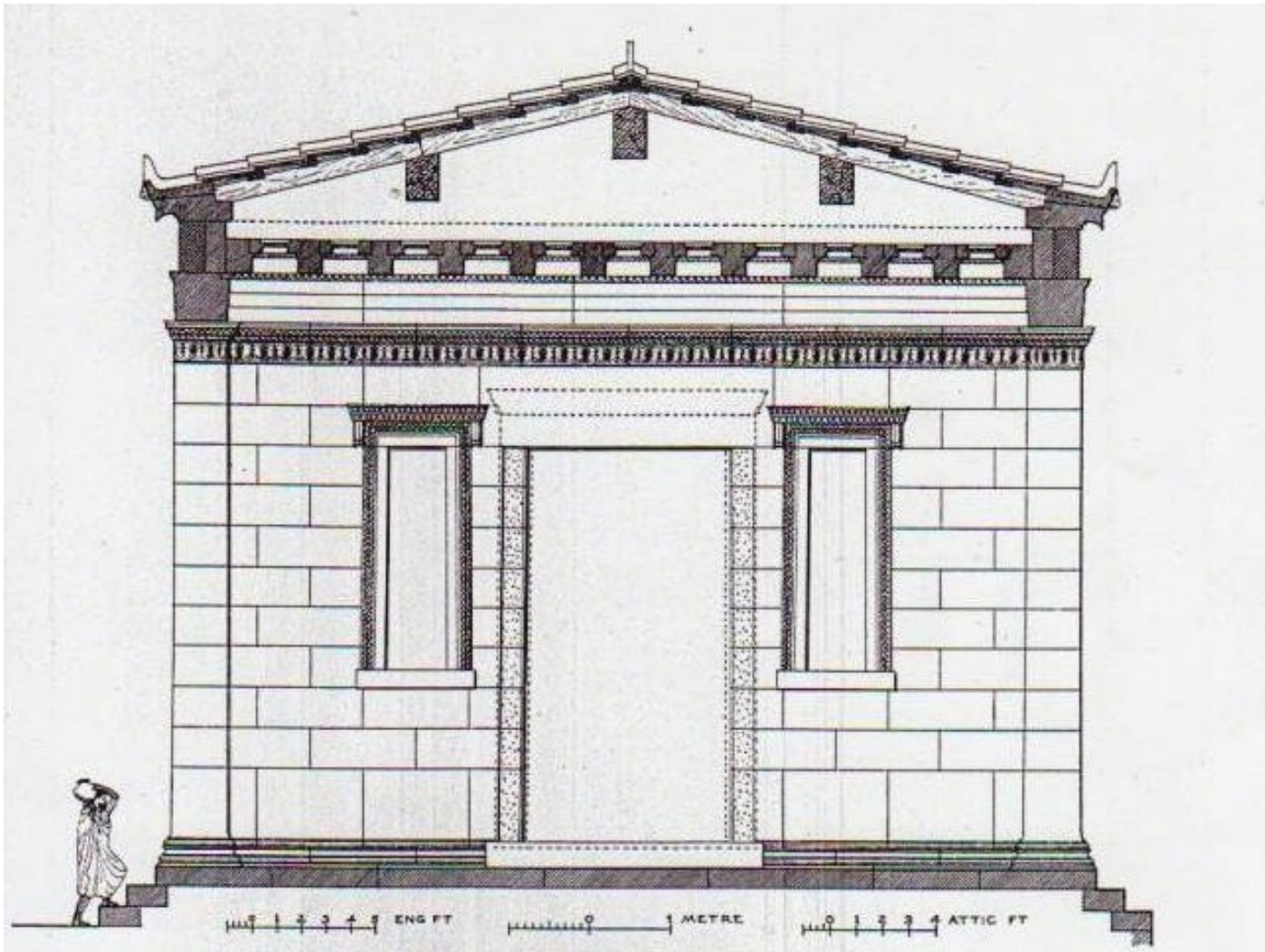

Ο ανατολικός τοίχος του ναού χωρίς την πρόσταση.

THE NORTH PORCH



87. Restored view of the Erechtheion from the northwest. (Watercolor by Peter Connolly)

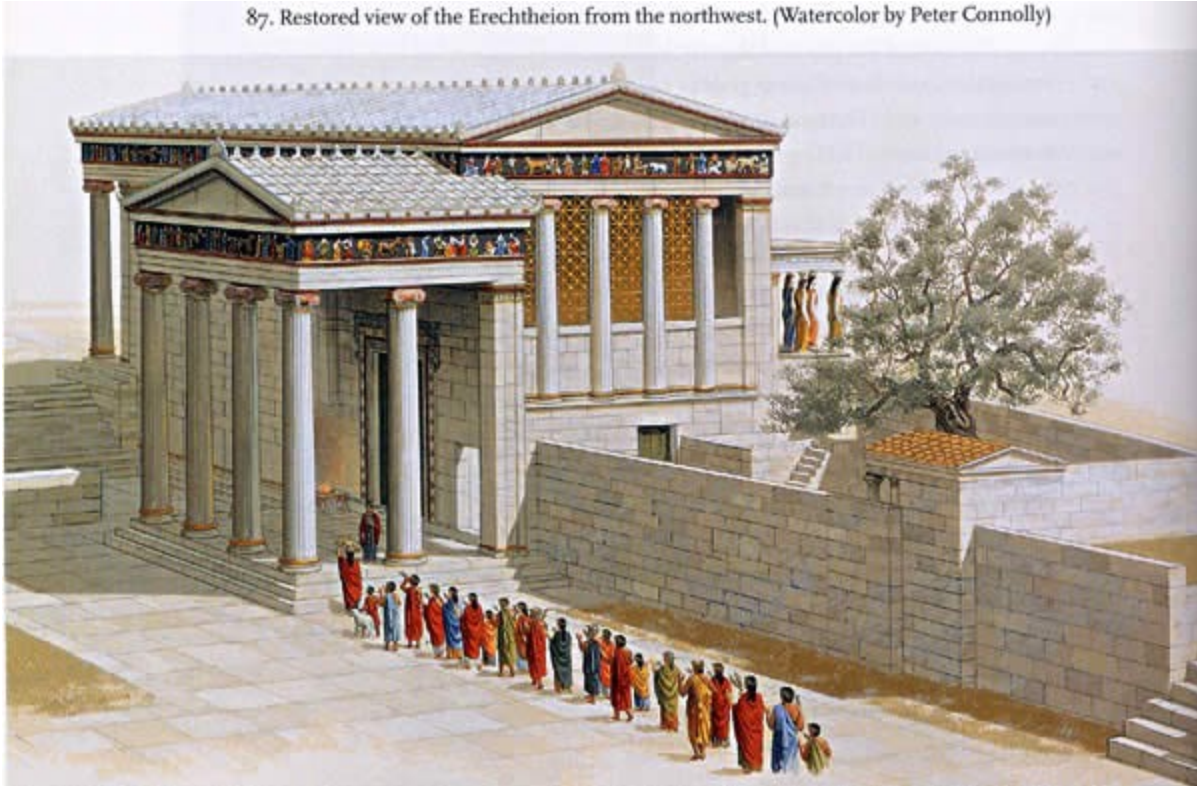

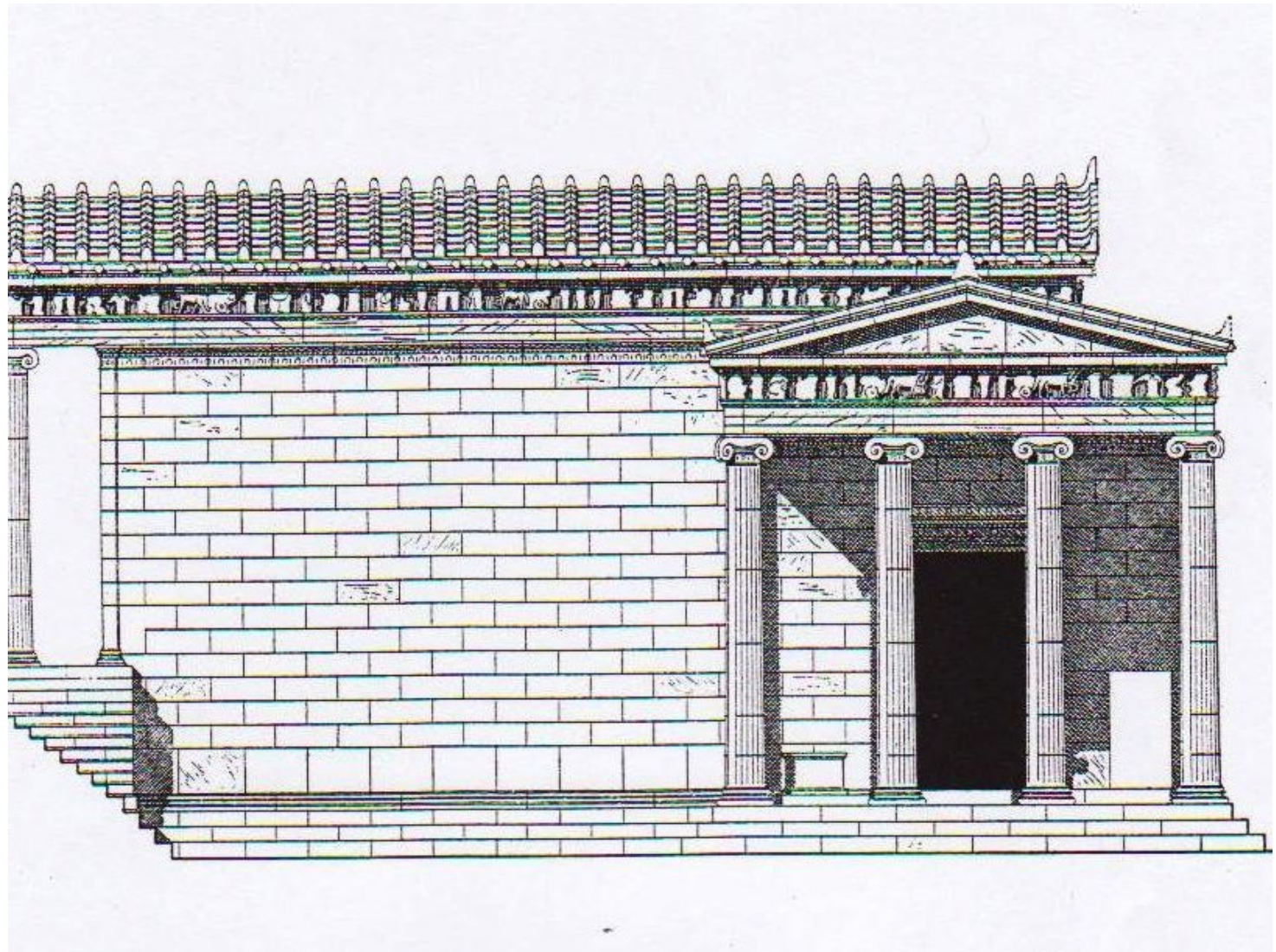

Η βόρεια πρόσταση.

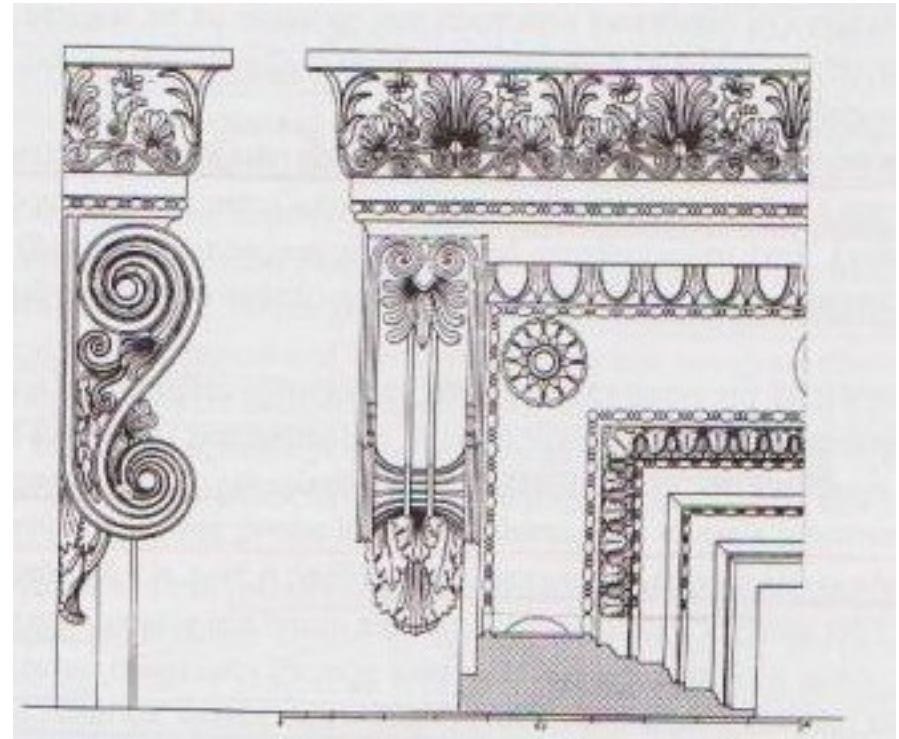
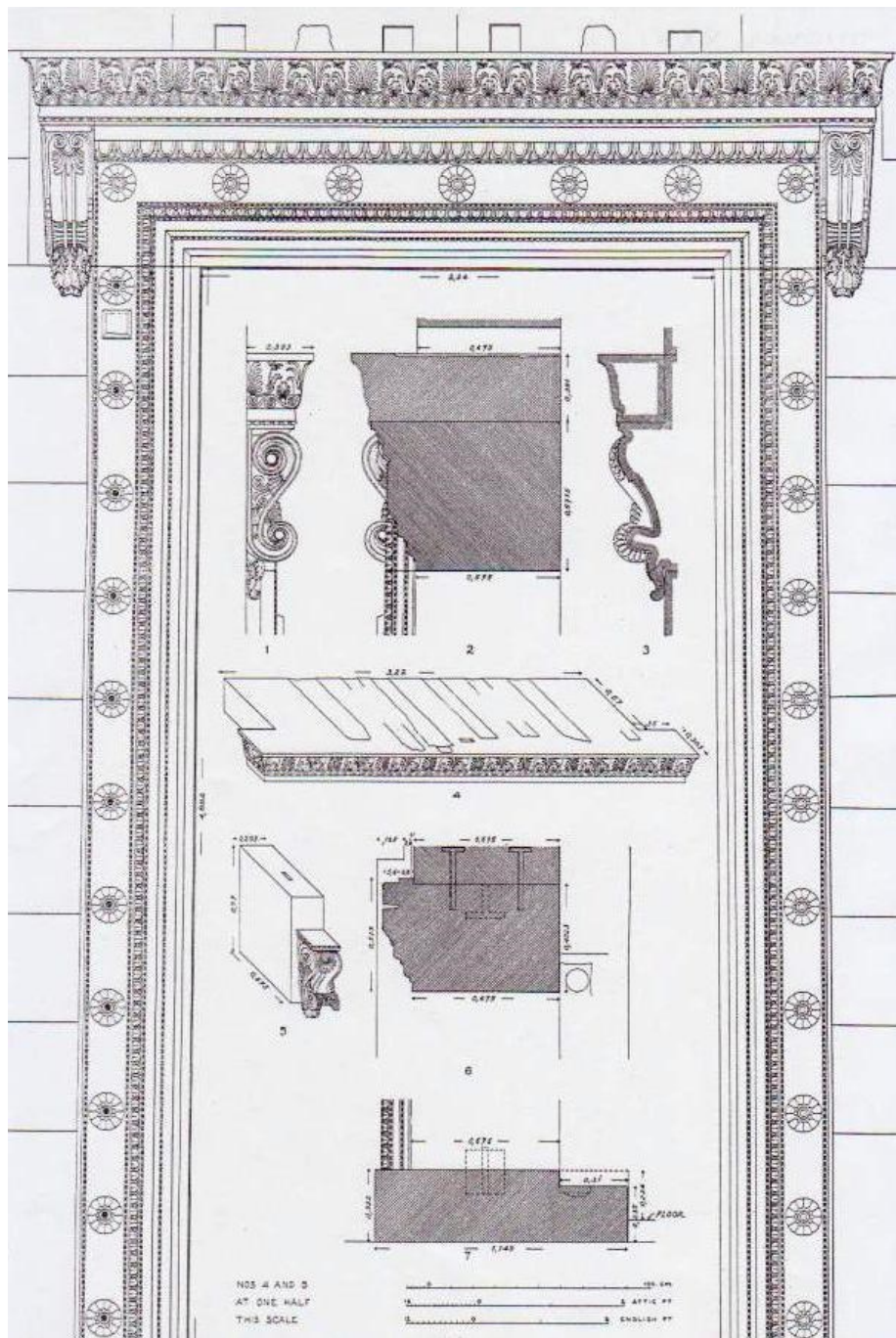

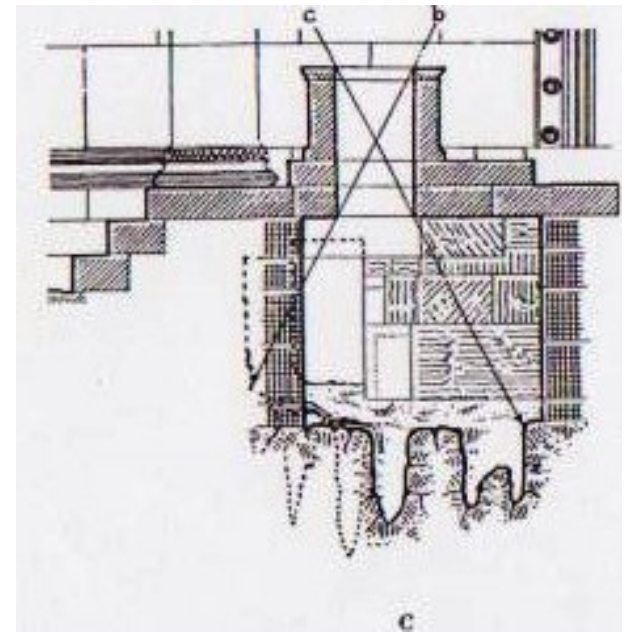
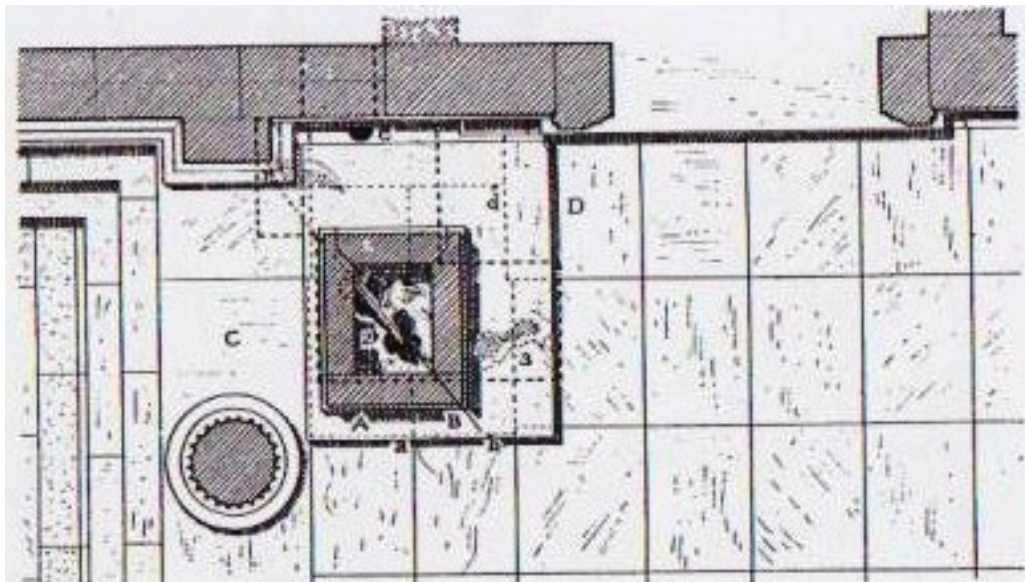



Η οροφή της βόρειας πρόστασης όπως σώζεται σήμερα.

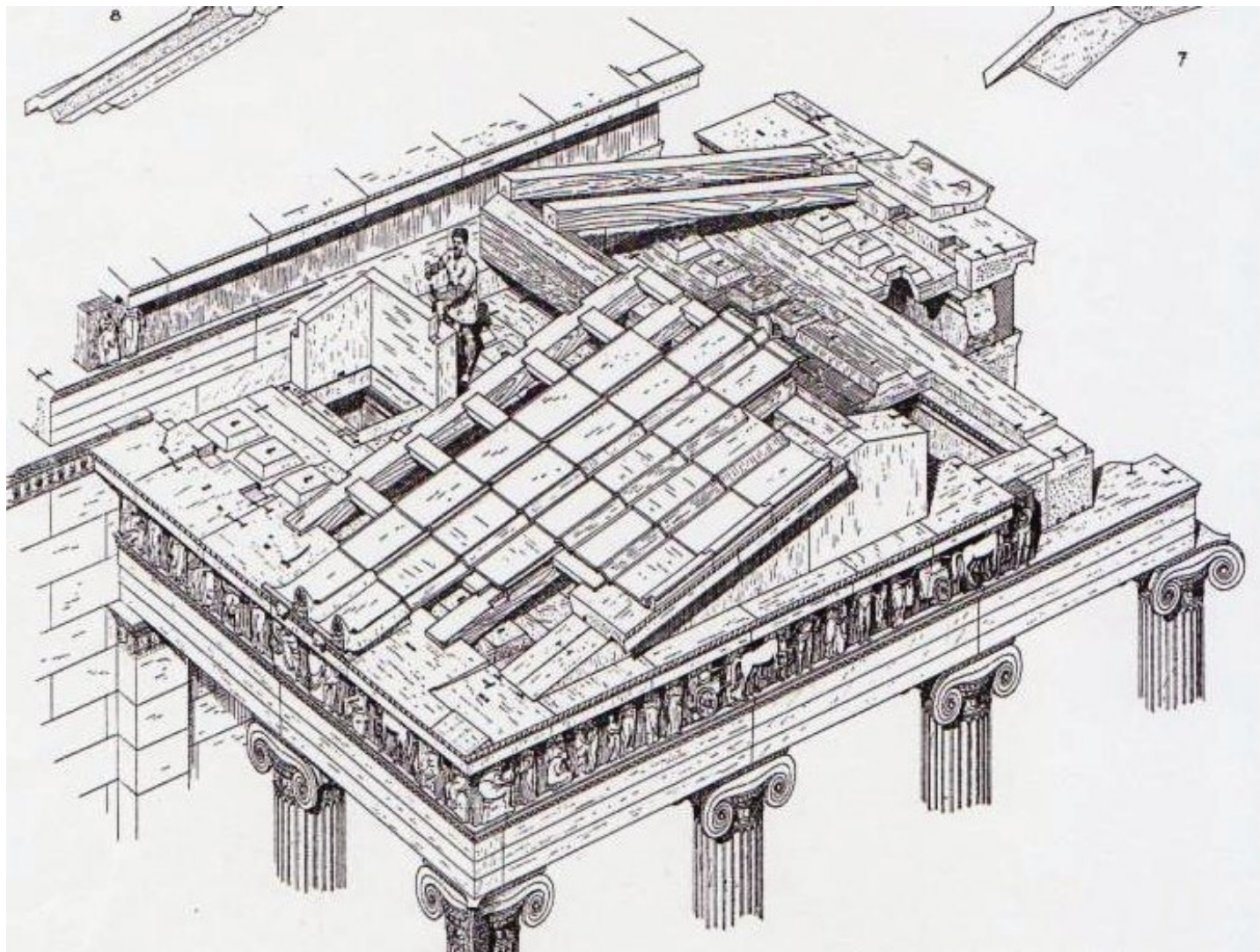

Υπαρξη ανοίγματος στην οροφή και τη στέγη της βόρειας πρόστασης.













«RICHLY DECORATED YET RELAXED»



THE PORCH OF THE CARYATIDS / MAIDS





